

1.	Power ON/OFF	2.	Reset	3.	AUX input	4.	Micro SD card slot
5.	Release button	6.	USB Charging	7.	Phone link/USB media		

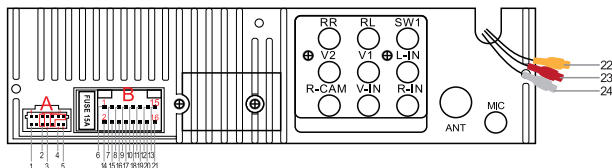

1.	A1 GND
2.	A2 USB
3.	A3 Brake detect
4.	A4 Amplifier control (B+)
5.	A5 Front Camera (B+)
6.	B1 GND
7.	B2 BATT
8.	B3 ACC
9.	B4 ILL
10.	B5 BACK
11.	B6 KEY1
12.	B7 KEY2
13.	B8 ANT
14.	B9 FR-
15.	B10 RL-
16.	B11 FR+
17.	B12 RL+
18.	B13 FL-

19.	B14 RR+
20.	B15 FL+
21.	B16 RR-
22.	Front Camera input (Yellow)
23.	RCA FR OUT (Red)
24.	RCA FL OUT (White)
RR	Rear right speaker output
RL	Rear left speaker output
SW1	Sub-woofer output
L-IN	Left speaker input
R-IN	Right speaker input
V-IN	Video input
R-CAM	Backup Camera input
V1	Video Output
V2	Video Output
MIC	External Microphone
ANT	Radio antenna

## IMPORTANT NOTICE & PRECAUTIONS

Thank you for using our company multi-media player! To operate the unit correctly, please read the operation manual carefully before using. Keep this operation manual for further reference.

The unit is designed only for DC 12V negative ground operation system. Make sure your vehicle is connected to DC 12V negative ground operation system. Be sure to connect the speaker(-) leads to the speaker(-) terminal. Never connect the left and right channel speaker wires together or to the vehicle body.

The normal temperature for operation is between 0 and +30 degree Celsius. Do not work in extreme high or low temperature and lock vents or radiator panels of the unit, blocking them will cause heat to build up inside the unit and may cause damage or fire.

This unit can play the following media files: RMVB / MPEG 4 / MP3 / WMA / JPEG.

## INSTALLATION

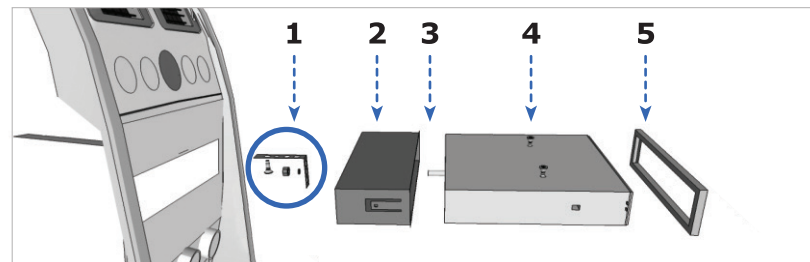

1. fixture accessories (if included): 1 x fixation metal sheet, 1 x bolt, 1 x nut, 1 x washer
2. installation frame
3. fixation bolt (if included)
4. unit
5. bezel (if included)

\* Installation frame is already firmly fixed to the unit's housing by delivery.

## MAIN UNIT OPERATION

Symbol / Function	Operations & Controls
RES / RST	Press with a pointed object (such as a ball point) to reset the unit to its initial setting by the factory (default stage).
⏻ / POWER	When the unit is turned off, press to turn on the unit. When the unit is turned on, press & hold shortly to turn off the unit.
M/N / MENU	Press to shift screen between MAIN MENU & current operation mode.
🔊+ / 🔊- / VOL+ / VOL-	press repeatedly to adjust sound output level.
MUTE / 🚫	Press to turn on or off of sound mute control.
IR	Remote control sensor for signal reception from remote handset.
AUX	Insert an external device to this jack in order to have sound output of that external device through the unit.
USB	Insert USB device to this slot for digital files playback.
MICRO SD / SD / MINI SD / 📁	Insert micro SD card to this port for digital files playback.
MIC	For voice reception under Bluetooth operation.
TFT SCREEN	It shows the status of operation on the unit. This screen is also a touch display – soft touch the screen for different operations of unit (refer to other parts of this manual for operation details).

### Note

The above mentioned symbols / functions / operations & controls show the operations for various version of the unit and may not be equipped or available for control in this unit. Printings and symbols on the above may be varied from the exact main unit. Referred to the main unit for exact functions and features that applied. User is highly recommended to use the touch screen control as well as the remote control handset to operate. Most of the operations of this unit cannot be controlled by the main unit.

## REMOTE HANDSET – GENERAL OPERATION

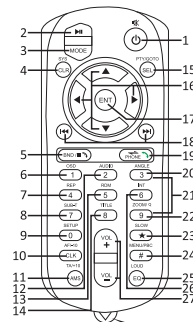

### BATTERY REPLACEMENT

Refer to the back of remote handset for details on how to replace the battery.

Remove this tab before using the remote handset

### NO. SYMBOL

1.	⏻	When the unit is turn off, press to turn on the unit. When the unit is turn on, press & hold shortly to turn off the unit.
2.	🚫	During unit operation, press to turn on or off of sound mute control
3.	▶▶	At disc / USB / SD / input & Bluetooth mode, press to pause, resume or start playback.
4.	MODE	Signal Source.
5.	SYS / CLR	At Bluetooth mode, press to erase the digit input by error.
6.	BND	<u>Radio Mode</u> Press repeatedly to select the desired radio band for broadcasting.
7.	■	<u>Disc / USB / SD Input Mode</u> At playback mode, press to stop playback and shift to playlist for playback selection (depend on the input device, playlist may not be available). Note: Not available for control at music playback mode
8.	📞	<u>Bluetooth Mode</u> Press to hang up or refuse an incoming call.
9.	OSD	At media playback mode, press & hold shortly to display the contents of the playback details on screen. (Note: Not available at music playback mode)
10.	REP	At playback mode under disc / USB / SD input, each time press & hold shortly to activate various repeat playback setting.
11.	SUB-T	<u>Video Playback Mode</u> Each time press & hold shortly to select different sub-titles that recoded in the input device or media files.
12.	SETUP	During unit operation, press & hold shortly to activate setup menu on screen for various setup of the unit. Press & hold shortly again to return to previous operation mode. (Note: Setup of unit cannot be operated by remote handset. Setup of unit can only be operated by touch screen – refer to ON SCREEN OPERATION for details)

10. AF/-10 /CLK In the Radio mode of RDS, the frequency will adjust automatically. When playing MP3, press and hold to enter track selection, briefly press to set the CLOCK.
11. TA/+10 /AMS In the Radio mode, briefly press for auto search. In the radio mode of RDS, press and hold for TA. When playing MP3, press and hold to select track.
12. AUDIO At video and music playback mode, each time press & hold shortly to select different audio output channels. (Note: Available on input device or media files recorded with different output channels and this selection is not available under Bluetooth mode)
13. RDM At disc / USB / SD input playback mode, press & hold shortly to turn on or off of random playback of the input device. (Note: Not available at photo playback mode)
14. TITLE DVD Mode  
Press & hold shortly to display on screen the title of the disc for setting/setup.
15. PTY/GOTO/  
SEL In the Radio model of RDS, it will be PTY.  
In the DISC playback mode, press and hold to select track, briefly press to select volume.
16. ▲/▼/▶/◀ DVD Mode  
At DVD menu/title display mode, press to select the desired setting/setup and press ENT to confirm/enter.
- Folder / Playlist Mode  
During folder/playlist display at media playback mode, press repeatedly to select track for playback. Once selected, press ENT to confirm.
- Photo Playback Mode  
Press to rotate photo position or show up-down, left-right mirror image.
17. ENT DVD Mode / Folder/Playlist Mode  
At DVD menu/title display mode as well as folder/playlist display at media playback mode, press ▲/▼/▶/◀ to select the desired setting/setup and press ENT to confirm/enter.
18. ⏮/⏭ Radio Mode  
Press repeatedly to fine tune radio frequency upward or downward.  
Press & hold shortly to tune radio frequency upward or downward and stop for broadcasting when a station received.  
Disc / USB / SD Input Mode (Playback Mode)  
Press repeatedly to shift track upward or downward for playback.  
Each time press & hold shortly to activate various speed of fast forward or fast rewind mode. (Note: Not available for operate at photo playback mode)  
Bluetooth Mode  
Press to shift track upward or downward for playback.  
TV Mode  
Press repeatedly to shift upward or downward for playback.  
Press & hold shortly to turn frequency upward or downward and stop for broadcasting when a channel received.
19. 🔓 Bluetooth Mode  
Press to pick up an incoming call; dial out after input a phone number; redial last dial out number.

- ☎ / PHONE Bluetooth Conversation Mode  
Press & hold shortly to shift conversation between main unit and mobile phone.
20. ANGLE At video playback mode, each time press & hold shortly to view angle changes in sequential order (available on media files recorded with this features).
21. 1 – 6 Radio Mode  
Press any one of the number key 1-6 to select a station that had been stored in the preset memory number key 1-6 for broadcasting.  
0 – 9 Disc / USB / SD / Input Mode  
Press directly to input the number of track for playback.  
Bluetooth Mode  
Press directly to input the phone number for dial out.  
TV Mode  
Press directly to input the channel number for broadcasting
22. ZOOM Disc / USB / SD Input Mode  
At video & photo playback, each time press & hold shortly to select various zoom in and zoom out of screen for viewing.
- 🔍 Radio Mode  
Press to start scanning all the preset stations on memory and stop for a few seconds for broadcasting.  
Press & hold shortly to start searching the frequency and storing the strongest signal stations into the preset memory stations number 1-6. After storing the stations, the unit starts scanning all the preset stations on memory and stop for a few seconds for broadcasting.
23. SLOW At DVD playback mode, press repeatedly to select different speeds on slow motion playback.
24. MENU / PBC DVD Mode  
Press & hold shortly to display on screen the menu of the entire disc for setting/setup.  
VCD Mode  
Press & hold shortly to turn on or off of PBC playback.
25. EQ Press repeatedly to select the desired preset equalization mode.  
LOUD Press & hold shortly to turn on or off of loudness control.
26. INT At music playback mode, press & hold shortly to turn on or off of intro playback of the input device. (Note: Not available at Bluetooth mode)
27. VOL + / VOL - Press repeatedly or press & hold to adjust sound output level.

Remarks: Depends on the input devices & playback media files, operation may be varied or not available for operation.

## ON SCREEN – MAIN MENU OPERATION



During unit operation and when this icon appeared on screen, touch to shift screen to **MAIN MENU** for selection of various operation or setup modes.

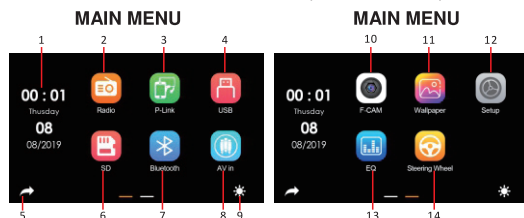

Touch the icon on the desired mode on screen and the unit will then enter into the mode that selected for operation. Hold & slide on screen to shift to other **MAIN MENU** that shows the hidden input or operation icons.

1. Touch to shift screen to **CALENDAR MENU** for calendar & clock setup.
2. Touch to start radio operation (when the radio antenna connected).
3. Touch to start mobile phone mirror linking operation (when the mobile phone connected ).
4. Touch to start USB input operation (when an USB device inserted).
5. Touch to shift back to previous operation mode.
6. Touch to start SD card input operation (when a micro SD card inserted).
7. Touch to start Bluetooth operation (when the mobile phone paired with the unit)
8. Touch to start auxiliary input operation (when an auxiliary device inserted).
9. Touch repeatedly to select brightness of screen or turn off the screen. Turn off of screen is available under headlamp detection at OFF mode. When the screen is off, touch any portion of the screen to turn it on again. Following preset brightness modes can be selected.
10. Touch to start viewing front camera (when connected to front camera and pink/black wire).
11. Touch repeatedly to select the desired background (wallpaper) of the unit.
12. Touch to activate **SYSTEM SETUP MENU** on screen to have various setup of the unit.
13. Touch to select to desired preset equalization mode.
14. Touch to Make steering wheel control settings.

## ON SCREEN – SETUP OPERATION



At **MAIN MENU**, touch to shift screen to **SETTING MENU** for various system setup of the unit.

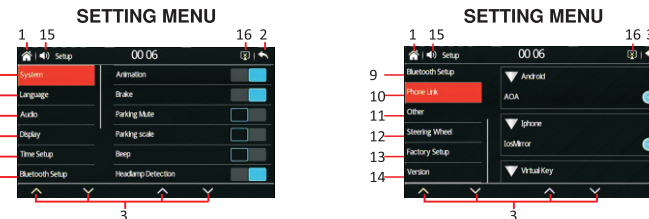

Hold & slide up/down on screen to show the hidden **SETTING MENU** for various setup of the unit.

1. Touch to shift screen to **MAIN MENU**.
2. Touch to shift to previous menu or operation mode.
3. Touch to roll the page up and down.
4. Touch to shift to **SYSTEM SETUP MENU** for various system setting (Refer to SYSTEM SETUP).
5. Touch to activate LANGUAGE INTERFACE to select the desired system language on screen.
6. Touch to shift to **AUDIO SETUP MENU** for various audio setting (Refer to AUDIO SETUP).
7. Touch to shift to **VISUAL SETUP MENU** for various visual setting (brightness,contrast,hue, saturation,sharpness)
8. Touch to shift to **CALENDAR SETUP MENU** for calendar & clock setting (Refer to CALENDAR & CLOCK SETUP).
9. Touch to shift to **BLUETOOTH SETUP MENU** for various Bluetooth setting (Refer to BLUETOOTH SETUP).
10. Touch to shift to **PHONE LINK SETUP MENU** for relevant settings.
11. Touch to shift to access other relevant settings
12. Touch to shift to **SWC SETUP MENU** for steering wheel control setting (Refer to STEERING WHEEL CONTROL SETUP).
13. Touch to enter reset setup. At this mode, touch the arrow to reset the unit at its ex-factory default stage.
14. Touch to shift to **VERSION MENU** to show details of the unit (Refer to VERSION OF UNIT).
15. Touch to activate the volume control bar on screen, hold & slide to adjust the output level on volume.
16. Touch repeatedly to select brightness of screen or turn off the screen. When the screen is off, touch any portion of the screen to turn it on again

## ON SCREEN – RADIO OPERATION



At **MAIN MENU**, touch to shift screen to **RADIO MENU** for radio operation.



1. Touch to Select station with FM frequency.
2. Touch to Select station with AM frequency.
3. Touch to Search and save band automatically.
4. Touch to tune the radio frequency to upward or downward station for broadcasting. Touch & hold shortly to activate manual tuning mode. At this mode, touch repeatedly to fine tune radio frequency upward or downward.
5. Touch to select stereo (STEREO) or mono (MONO) mode at FM radio band. When stereo signal received, ST indicator will be highlighted on screen and this is no indicator for mono signal.
6. Touch the desired preset station to start broadcasting. Touch & hold shortly the desired preset station can store the current broadcasting station (frequency) into that station.
7. Touch repeatedly to select desired preset equalization mode.
8. Touch to activate the PRESET STATIONS MENU on screen.
9. Touch repeatedly to select brightness of screen or turn off the screen. When the screen is off, touch any portion of the screen to turn it on again
10. Touch to Touch to shift to previous menu or operation mode.
11. Touch to activate the volume control bar on screen, hold & slide to adjust the output level on volume.
12. Touch to shift screen to **MAIN MENU**.

## ON SCREEN – BLUETOOTH OPERATION

### LINK UP WITH MOBILE PHONE

To linkup Bluetooth connection with the mobile phone, take your phone and follow the steps:

- set the mobile phone to Bluetooth state
- start to search new device
- after searched, new device "CAR-BT" searched out, confirm the search
- in case of need, input default code "0000" or "8888" in the mobile phone
- at the same time, Bluetooth icon on screen will be highlighted
- connection succeeded and you can start using Bluetooth function



At **MAIN MENU**, touch to shift screen to **BT MAIN MENU** for Bluetooth operation (when a mobile phone has been linked up with the unit).

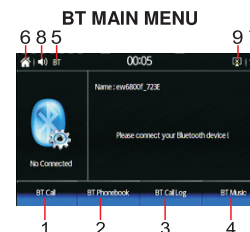

1. Touch to shift to **BT MAIN MENU** for dial out of phone.
2. Touch to shift to **BT PHONE BOOK MENU** to show the phone book of the connected mobile phone.
3. Touch to shift to **BT RECORD MENU** to show the record on incoming calls / dial out numbers / missing calls of the connected mobile phone.
4. Touch to shift to **BT MUSIC MENU** for transmission of music playback from the connected mobile phone.
5. Touch to start Bluetooth operation (when a mobile phone linked up with the unit and this icon high-lighted).
6. Touch to shift screen to **MAIN MENU**.
7. Touch to shift to previous menu or operation mode.
8. Touch to activate the volume control bar on screen, hold & slide to adjust the output level on volume.
9. Touch repeatedly to select brightness of screen or turn off the screen. When the screen is off, touch any portion of the screen to turn it on again



## DISPLAY MIRRORING-ANDROID MIRROR LINK

(for iPhone 6-7-8 series Mirror Link capable telephones)

The special feature of the device is to display the image of a mobile phone which is connected with USB cable and which has Android operational system on the large touchscreen as a secondary display. All applications on your mobile phone are displayed in portrait or landscape format, depending on the position of the phone, and can be controlled from the radio's touch screen without touching the phone. For example, music, movies, and other content, as well as internet radio, maps, navigation applications, POI databases, or music from the phone's memory or online.

First, make sure that you have a "QR Code" reader application on your phone. If you have not, install a free version from the Google Play app store.

Then select **PHONE LINK** from the main menu. Two QR codes and some instructions will appear on the screen. Download the **AUTOLINK** application to install on your phone:



Vehicle multimedia  
entertainment APP  
Autolink  
SunMedia Technology co., Ltd



„**AMAZON**“ QR code link; free download directly from the website to the phone:

<https://s3-ap-southeast-1.amazonaws.com/productscenter/release/venus/bootes/common/Autolink.apk>

[http://www.autolink.site:8080/jeesite//static/apk/Autolink\\_basic.apk](http://www.autolink.site:8080/jeesite//static/apk/Autolink_basic.apk)

„**GOOGLE**“ QR code link; free download from Google Play store

<https://play.google.com/store/apps/details?id=com.link.autolink>

As the third option, you can locate and install the **AUTOLINK** application with the logo above manually from the Google Play store.

• Download a file directly from the website to your phone and install the application independently of the store, such as the „**AMAZON**“ link.

After installing the application, connect the phone with a USB data cable.

Instructions on the screen:

CONNECT PHONE:

1. OPEN USB DEBUGGING

2. CONNECT USB LINE

Set the phone correctly:

-SETTINGS menu/ Developer options/

USB debugging/USB CONNECTION:ON (enable!)

-Below the previous menu item:USB TROUBLESHOOTING  
RELEVANT PERMITS:ON (enable!)

- This question usually automatically appears on the phone's opening screen or on its scrollable informational window after connecting the USB cable. Allow it to be permanently, so that it does not need to be repeated after each connection!
- It is recommended to have the screen lock switched off for easier operation or to set an unlocking mode on the phone, which is easier even from the car radio.

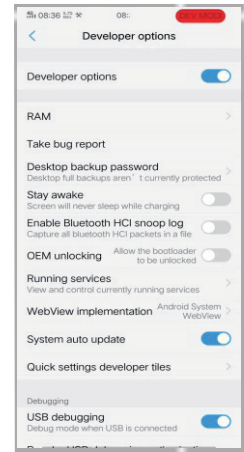

Android screen mirroring is only available if the **AUTOLINK** application is installed and the USB troubleshooting mode, as well as sharing data security setting is permitted on the phone. Unlock the screen lock on the phone and connect the phone's cable to the radio's USB socket. If the connection process does not happen automatically, touch the **CONNECT PHONE** (connect phone) button on the car radio screen. When a successful connection is made the image of the mobile phone immediately appears on the screen.

In case of connection failure:

-Verify that AUTOLINK is installed on your phone

-Try another USB connection cable

-Restart your phone and check developer, USB connection settings, and data sharing permissions

-Verify that your Android phone is suitable for such use (Android 5.0 and newer, with Mirror Link compatibility)

- If the image does not rotate when the phone is rotated, then check if the image-rotation is permitted in the scrollable menu. You can do this with local controller menu, which appears after tapping the white, unlabeled button on the car radio's left side.
- The picture is transmitted via the USB cable to the car radio while the sound is over the wireless BT connection. Meanwhile, the phone battery is charging.
- The USB cable must have a data transfer function in addition to the charging function. In general, the cable supplied with your phone is good.
- Due to the significant differences between mobile phones and their operating systems, there may be malfunctions and incompatibilities that are not caused by this device. The application which insures connection is a product of a third therefore its operation, development, and changes are independent of the manufacturer of this product.
- The screen mirroring and other functions described in this manual cannot be guaranteed in any case in existence of reasons independent of the manufacturer.

**SPECIFICATION**

<b>GENERAL</b>	
Power Requirement:	DC 12 Volts, negative ground
Load Impedance:	4 Ohms
Maximum Power Output:	60 watts x 4 (RMS)
Tone Control – Bass (at 100 Hz)	+/- 8 dB
Treble (at 10 KHz)	+/- 8 dB

<b>FM RADIO SECTION</b>	
Frequency range (America)	87.5 – 107.9 MHz
Frequency range (Europa)	87.5 - 108 MHz
Usable Sensitivity (-20 dB)	15 dB
Signal to Noise Ratio	60 dB
Stereo Separation (at 1 KHz)	30 dB
Frequency Response	30 Hz – 15 KHz

<b>AM RADIO SECTION</b>	
Frequency range (America)	530-1710kHz
Frequency range(Europa)	522-1620 kHz
IF frequency	450 MHz

<b>VIDEO SECTION</b>	
Video System:	PAL / NTSC
Video Output Level:	1.0Vp-p 75 Ohms
Horizontal Resolution:	500

<b>BLUETOOTH SECTION</b>	
Communication type:	V2.1
Maximum Distance:	5 meters

<b>AUDIO SECTION</b>	
Maximum Output Level:	2 Vrms (+/-3 dB)
Frequency Response:	20 Hz to 20 KHz
Signal to Noise Ratio:	85 dB
Channel Separation:	80 dB

Note: Specification and design; functions and features; unit illumination; colour and display segment are subject to change without prior notice. Photos and drawings on gift box or operation manual might be varied from the exact unit. Depends on the input devices, operation might be varied from the operation manual described.

**SIMPLE TROUBLE SHOOTING**

PROBLEMS, CAUSES & SOLUTIONS
<b>No power</b> - Check and make sure the connecting wires are connected correctly - Check whether the fuse is blown. Replace with the proper value fuse if necessary.
<b>No sound</b> - Check and make sure the speaker wires are connected correctly.
<b>No picture</b> - Check whether the video wire is connected to the video device.
<b>Unit hang-up</b> - Reset the unit to its default stage.
<b>No function when pressing the buttons or TFT screen</b> - Reset the unit to its default stage.
<b>Poor effect or unable to receive radio</b> - Check whether the radio antenna is inserted or properly connected. - Antenna may not be the proper length. Make sure the antenna is fully extended. - Antenna may be poorly grounded. Check and make sure the antenna is properly grounded.
<b>Stereo cannot be received under radio mode</b> - Tune the radio frequency accurately. - The broadcasting signal is too weak, set the mode to MONO.
<b>Remote handset does not work</b> - Replace new battery of the remote handset. - Point the remote handset directly at the remote sensor of the main unit. - Clean the surface of the remote sensor.
<b>Bluetooth not operated</b> - check the devices are linked up correctly.

Note  
After the above efforts, if the unit still cannot be worked normally, consult your service dealer. Never attempt to disassemble the unit by yourself. No service part inside the unit.