

CAR AUDIO

CAR MP3 PLAYER WITH RAIDO USB/SD/MMC MANUAL

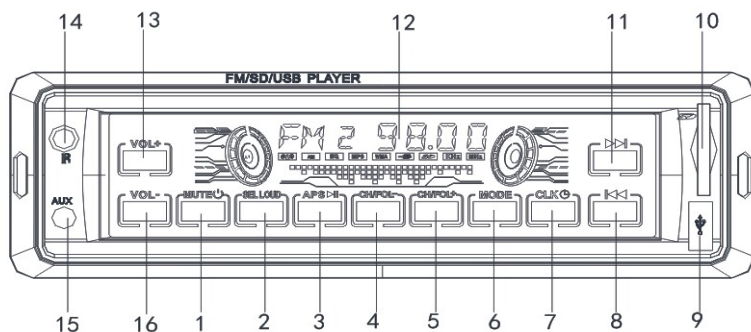

1. Power on / off / MUTE
2. Sound effect change
3. Pause/play/Change radio channel /Search automatically/Storage button
4. MP3 Previous Document/ FM Previous station
5. MP3 Next Document/ FM Next station
6. MODE
7. Clock
8. MP3 Previous song/FM Radio search backward/ Ring off
9. USB slot
10. SD/MMC slot
11. MP3 Next song/FM Radio search forward/Answer the call
12. LCD
13. Volume increase
14. Remote Control receive window
15. AUX in
16. Volume decrease

2. Basic Operation

This product is touch screen, short press any button can be power on.

1. Power on / off / Mute (1)

After turning on the power begin working, press any button to power on. Short press (1) is Mute function, long press (1) is power off.

2. Sound effect change (2)

Turn this button (2) to control the volume. Short press SEL (2) to choose the sound effect as follows:

Volume—BASS—TREBLE—FAD—BAL—EQ—Volume

When you choose the mode you need, you can press button (13) or (16) to select.

Long press button(2) to go to loudness function.

3. Pause/play/Change radio channel /Search automatically/Storage button(3)

In radio mode, short press this button(3) repeatedly to change the band: FM1-FM2-FM3. Long press this button to search and store the radio station into the memory number automatically.

Press button(4) and (5) to choose the radio stations that you have stored .

4. Mode(6)

Short press this button, you can change the mode as follow :FM—SD—USB—AUX IN.

5. LCD (12)

It shows radio frequency/and content of SD/USB.

6. Radio search backward button (8)

In the radio mode, short press (8) button to search the radio backward automatically. and it will stop and play when it get the radio station.

Long press this button to search the radio by manual, then you can short press this button to search the station, and if you don't press any button for 5 seconds, it will quit this function.

7. FM Radio search forward (11)

In the radio mode, short press (11) button to search the radio forward, and it will stop and play when it get the radio station.

Long press this button to search the radio by manual, then you can short press this button to search the station, and if you don't press any button for 5 seconds, it will quit this function.

8. Clock (7)

In the radio mode, press (7) button to display the current time. Long press (7) button again until the clock time flash, then you can press button (13) and button (16) to adjust time (hour) respectively. Then short press button (7) . The minute digits will flash . you can press button (13) and button (16) to adjust time (minute) respectively.

9. Aux in (15)

In radio/SD/USB mode, short press button (6) to go to AUX in mode, you can play external music by inserting in this Aux in hole.

10.SD/MMC slot (10)

Insert SD/MMC card into slot, it will read the music of the SD/MMC card.

11.USB slot (9)

Insert U disk into USB Slot. it will read the music of U disk..

12.

1). Insert SD/MMC/USB into slot , short press number “1” button (3) is pause function. short press again can go on playing.

2).Insert SD/MMC/USB into slot, short press button (11), it will read the next song .

3). Insert SD/MMC/USB into slot, short press number “5” button (4) is last 10 songs function .Long press is last file function.

4).Insert SD/MMC/USB into slot , short press number “6” button (4)is next 10 songs function. Long press is next file function

3.Technical Parameters

FM Part and USB/SD/MMC Part:

Frequency Range-----	87.5MHz-108MHz
noise-limited sensitivity-----	FM≤26dB
signal to noise ratio (S/N)-----	≥45dB
Frequency Response-----	100Hz-10kHz(+10dB)
Channel balance-----	≤3 dB
Channel Separation -----	≤22dB
MP3 Signal to noise ratio (S/N)-----	≥55dB
Working voltage -----	12V DC
Real power output -----	4x 60W/14.4V
Speaker impedance -----	4Ω-8Ω
Size dimension-----	180mm(W)x52mm(H) vx135mm(L)

4. INSTALLATION/UNMOUNTING

Before installation check the power supply of the vehicle, the condition of the device and if all functions work properly on the device. Always use the supplied accessories for the mounting, using of different parts may result faulty operation. Make sure when you mount the device that it can not cause any injury in case of braking. Avoid the mounting on places where the device is exposed to direct heat, dust etc.

Installation of the device: Place the mounting face into the dashboard, push the clips of the frame then push the radio in until it stays secure and fastened.

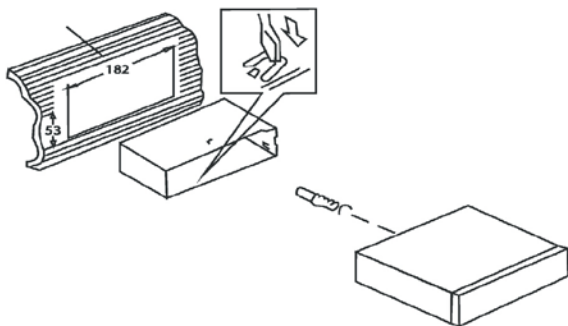

Unmounting of the device: Place the enclosed 'keys' (as seen on the picture) into the holes on both sides of the device until you hear a click sound, then pull the device-while holding the 'keys'-from the dashboard.

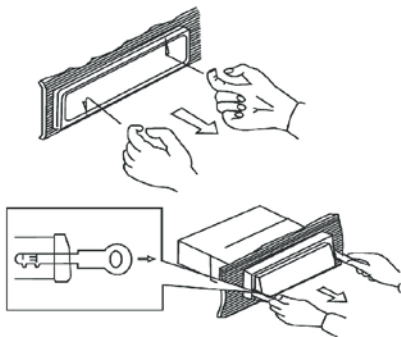

5. Wiring Diagram

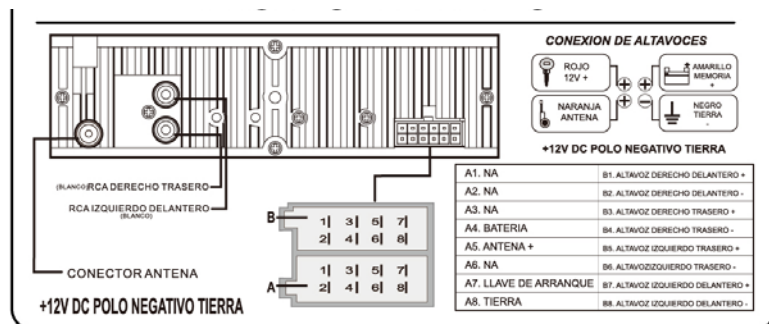

6. Trouble shooting

Fault	Reasons	Solutions
LCD doesn't display	<ol style="list-style-type: none">1. Yellow wire is not connected with battery +2. Fuse of red wire is open	Assure yellow wire is connected with battery + Replace fuse
No sound	<ol style="list-style-type: none">1. No power supply2. Speaker wire is open circuit3. SD/MMC card, U disk don't have song with corresponding format.4. SD/MMC card, U disk golden finger is dirt which causes bad contact.	Connect the power wire. Connect speaker wire. Check the contents of SD/MMC card, U disk. Clean with absolute alcohol.
Low sound (not clear)	<ol style="list-style-type: none">1. Power internal resistance is high.2. Antenna is bad contact.	Replace the power supply Tighten the antenna plug.
Mono track	<ol style="list-style-type: none">1. One channel of speaker wire is open circuit2. Amplifier integrated circuit is damaged.	Connect speaker wire Replace the IC of amplifier

Note: Technical data is subject to change without prior notify.